



These robust IP rated standalone keypads are designed to operate in both internal and external environments.

MTPAD Keypads incorporate metallic backlit keys in an aluminum slim line surface housing, available in a standard silver finish or charcoal, white, blue, red and green. With resin potted electronics all models are IP65 rated

They incorporate an easy to follow programming menu allowing up to 99 unique codes and the setting of relay output times. The units also includes an input to trigger the relay from a push to exit button.

Both audible and visual indication is standard indicating that a code is correct or incorrect while also helping to navigate through the programming menu.

Technical Characteristics

Codes:	99 User Codes (1 - 8 digits)
Relays / Outputs:	1 Relay - R1: (2A @ 24v DC / 120v AC) 1 Transistor Output - T1: (100mA)
Relay Time:	1 - 99 Seconds or latching (00)
IP Rating	IP65
Power:	12-24V DC; 15-24V AC
Current:	Standby 30mA / Maximum 100mA

Dimensions

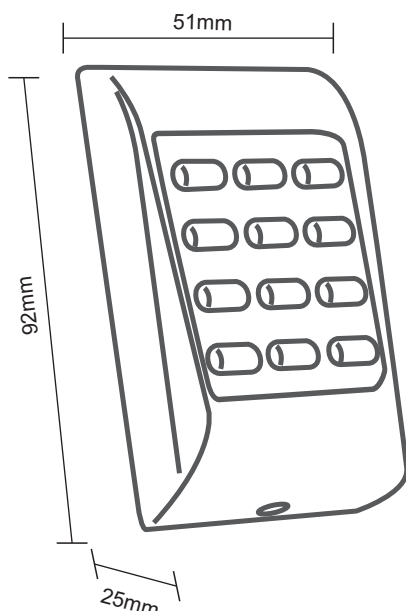



Installation Instructions

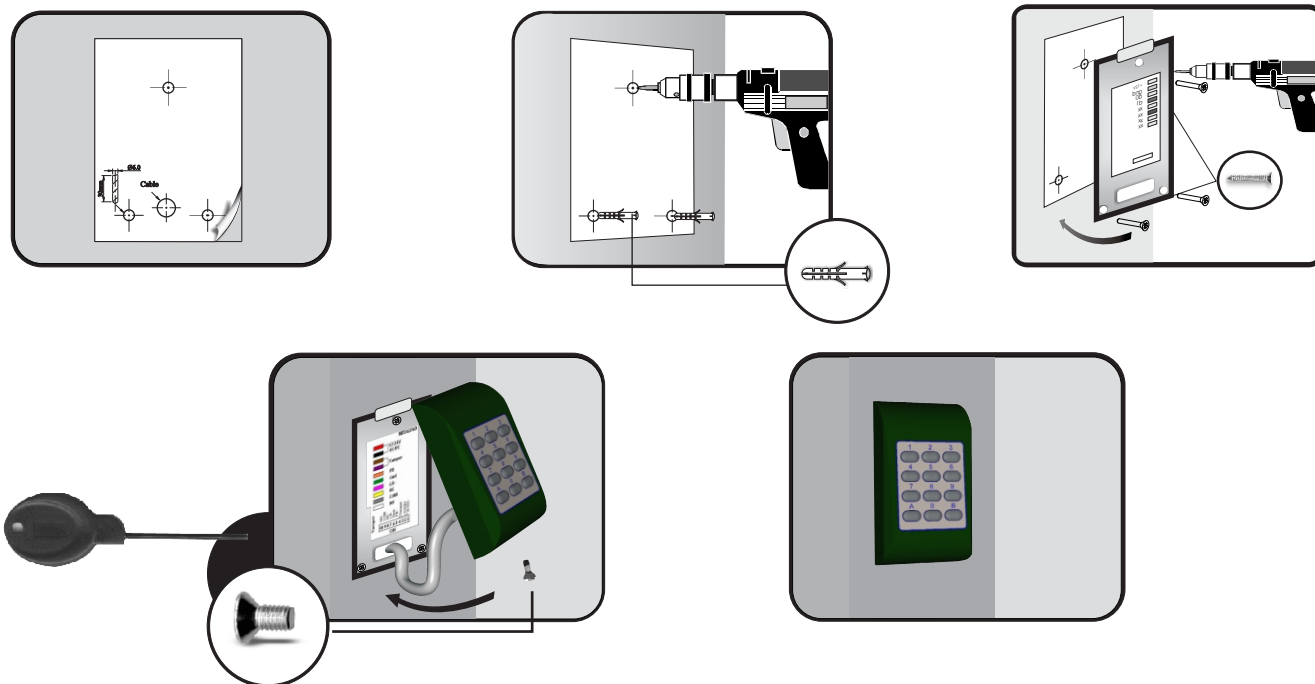

Terminal Connections

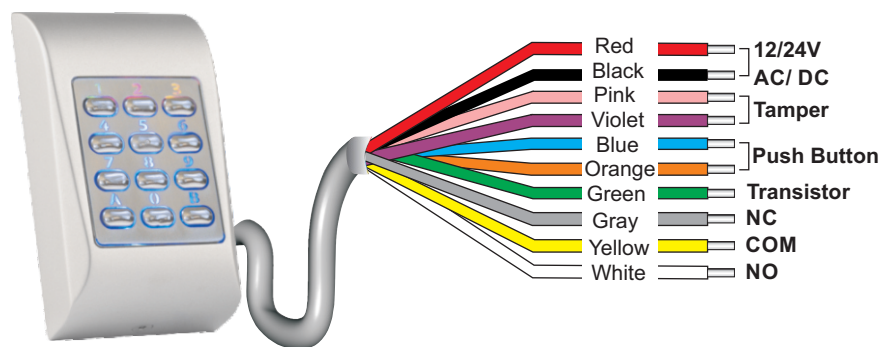

Colour	Connection
Red	12/24V AC/DC
Black	
Pink	Tamper
Violet	
Blue	Exit Button (NO)
Orange	
Green	Transistor
Grey	NC
Yellow	C
White	NO



Dip Switch Settings

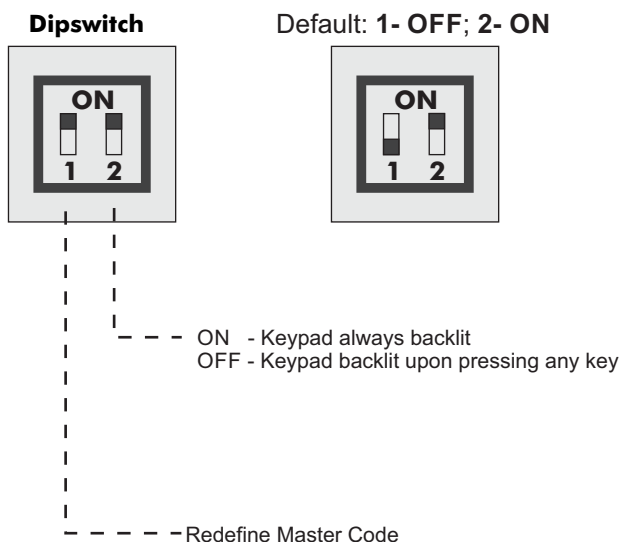

Green LED
Relay Status (Output1)

Red LED
Transistor Status (Output2)

Amber LED
Key press and Menu

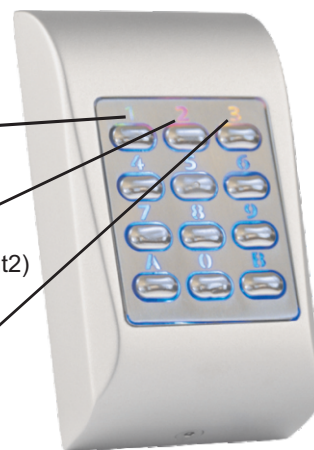

12v / 24v AC Wiring Diagram

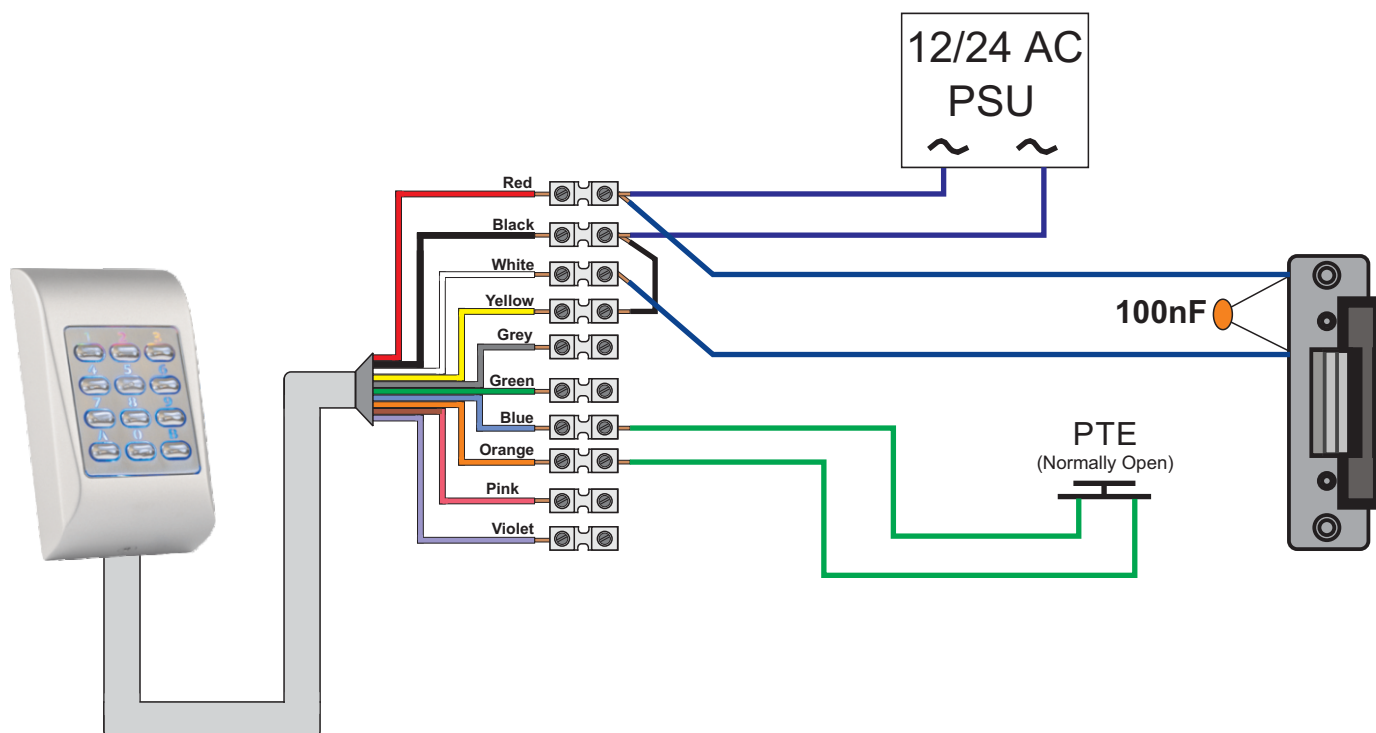



12v / 24v DC Wiring Diagram

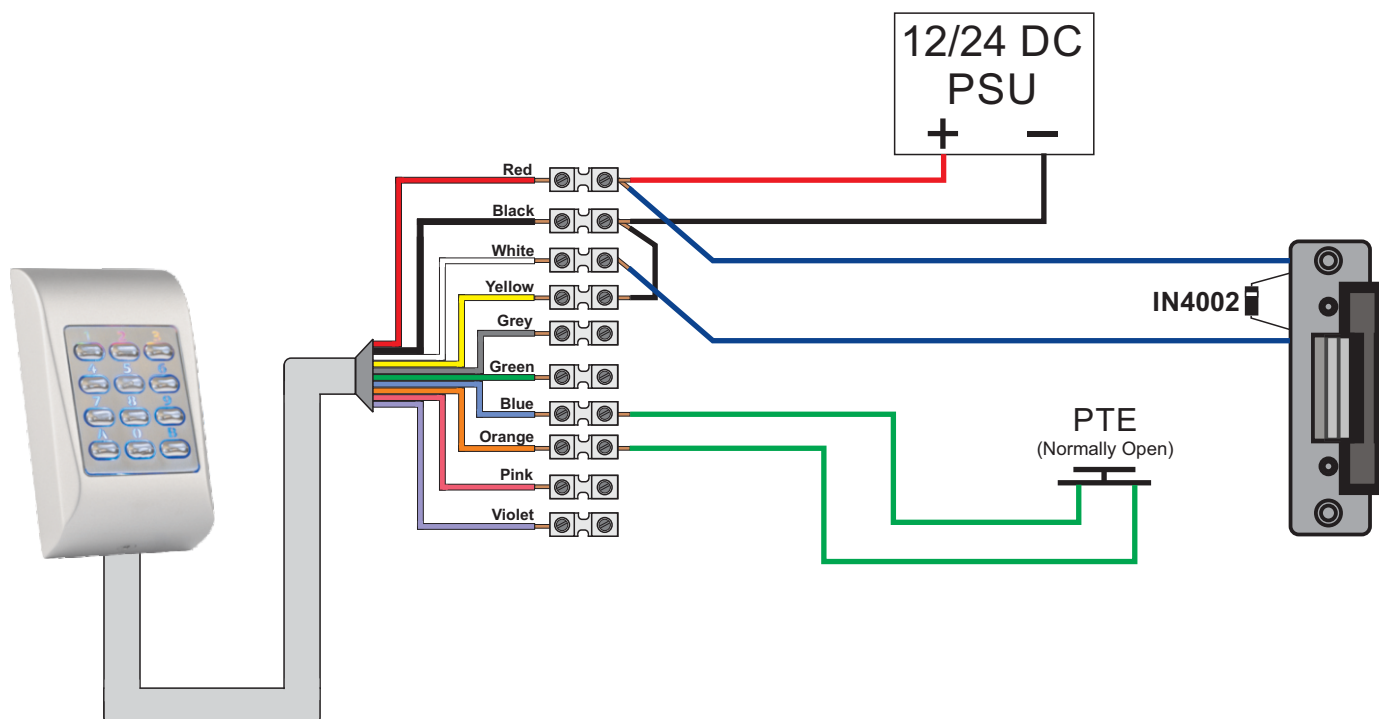

Using Transistor Output With a Art.506 Relay (12v dc)

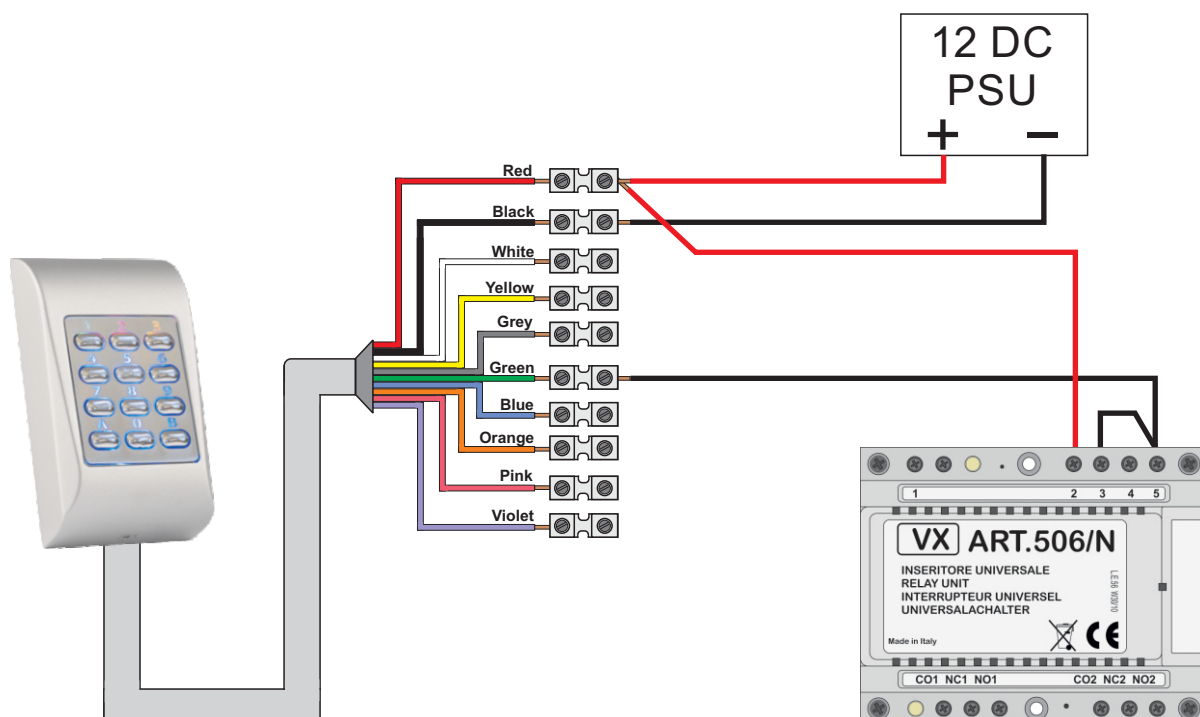



Adding a User Code

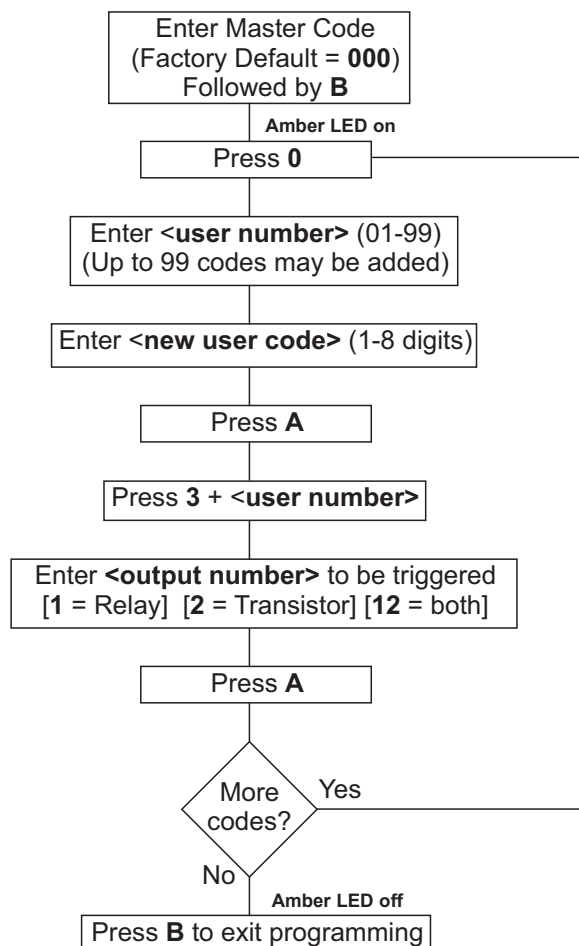

Delete All Codes

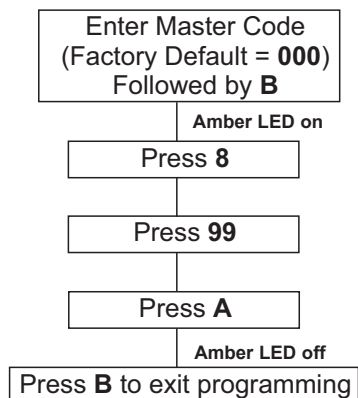

Relay/Output Time

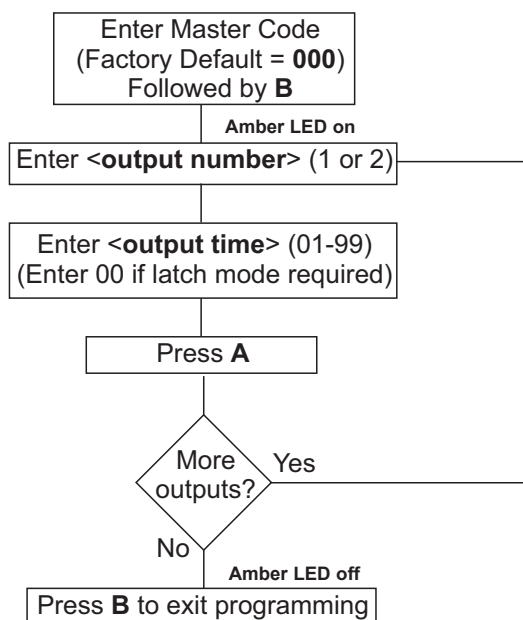

Delete a User Code

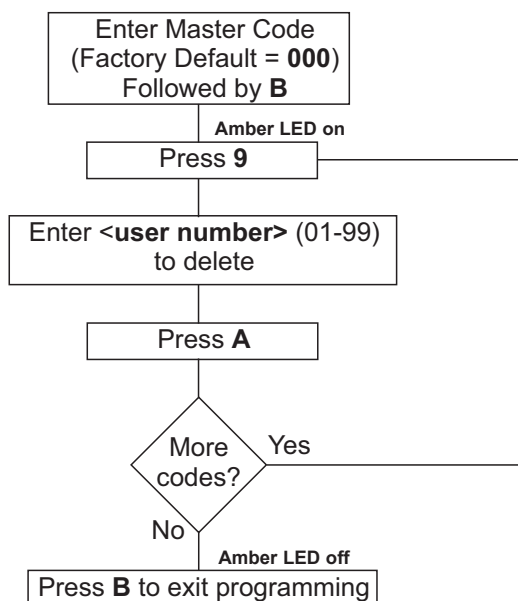



Resetting the Master Code

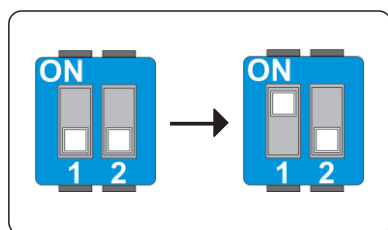

Disconnect power.
Switch on dip switch 1.
Reconnect power.
Beep Beep + Amber LED blinks

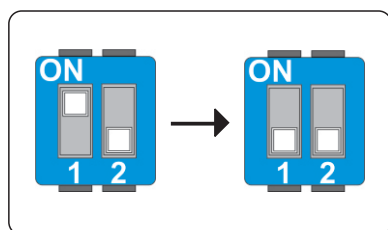

Switch off dip switch 1
Amber LED switches on + Long beep

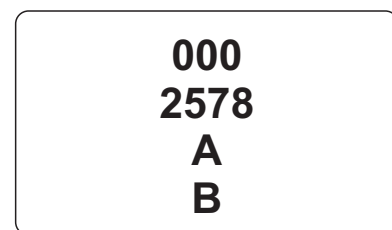

Enter the default master code 000 Enter
the new master code e.g 2578 Press A
followed by Beep Beep
Press B and the Amber LED switches off

Troubleshooting

Keypad does not respond to key presses

1. Check the correct voltage is present on the input terminals (12/24v ac/dc).

Keypad is not accepting default master code 000

1. Perform master code reset.

Keypad no longer accepts user code

1. Check master code has been changed from the default.
2. Check back EMF protection across lock release.

Keypad accepts user code but no longer releases lock

1. Check the correct relay output is assigned to user code.
2. Check push to exit button is normally open.
3. Check for continuity across relay contacts when user code is entered.
4. Check lock wiring for continuity.
5. Check the correct voltage is present on the input terminals (12/24v ac/dc).

Relay triggers and does not return back to its previous state

1. Check relay is not set up to latch



User Operation

Access Granted

Enter **<user code>** (1-8 digits)

Press **A**

1. Observe the amber LED as this will flash with each button press and the MTPAD will emit a single beep for each press (**Fig.1**).
2. The amber LED will flash twice and the MTPAD will emit a double beep (**Fig.2**).
3. The relevant relay will activate and the green LED will switch ON for the duration of the relay time (**Fig.3**).

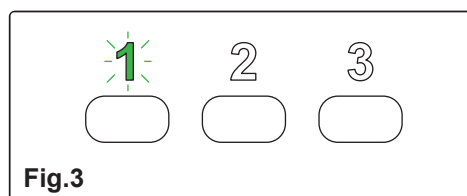
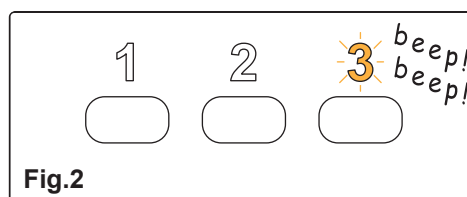
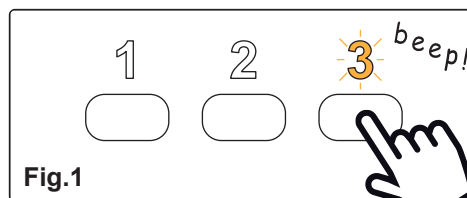

Access Denied

1. When an incorrect **<user code>** is entered the amber LED will continuously flash for approximately 5 seconds and no relay will operate.

Latching Mode

1. When the relay has been setup in latching mode (relay time set for 00), enter the **<user code>** then press **A** to latch the relay.
2. The amber LED will flash with each button press (**Fig.1**) as the **<user code>** is entered and will emit a single beep with each press.
3. Once the **A** button has been pressed the amber LED will flash twice and the keypad will emit a double beep (**Fig.2**).
4. The relevant relay will activate and the green LED will switch ON and stay ON until the relay is unlatched.
5. To unlatch the relay enter the **<user code>** then press **A**, the green LED will switch OFF and the relay will reset.

Northern Office

Videx Security Ltd
Unit 4-7 Chillingham ind Est
Newcastle Upon Tyne
NE6 2XX
Tel: 0870 300 1240
Fax: 0191 224 5678

Southern Office

1 Osprey
Trinity Park
Trinity Way
London
E4 8TD
Fax: 0208 523 5825

Technical Support

tech@videxuk.com
Tel: 0191 224 3174
Fax: 0191 224 4938
<http://www.videxuk.com>