

OVERVIEW

ART. 3171

3000 Series full base "2 wire BUS" digital audiophone which incorporates an electronic call tone with an adjustable 3 level volume control.

It also includes a "door open" push button and spare service button.

For use on the VX2200 digital audio and video systems.

Call tone adjustment: 3 level (low, medium and high) call tone switch.

No. of rings adjustment: 2 way internal jumper (3 or 6 rings).

3000
SERIES

3171 3000 Series Audiophone QUICK GUIDE



TECHNICAL SUPPORT

Tel: 0191 224 3174

Fax: 0191 224 4938

Email: tech@videxuk.com

Web: www.videxuk.com

QG_3171_V1.0_03/17



ANSWERING A CALL

beep! beep!

During a call

1



To answer an incoming call pick up the handset.

2

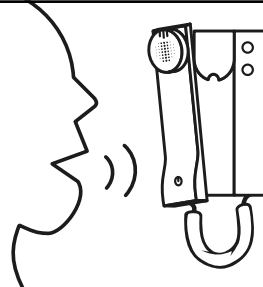

With the handset lifted a conversation with the caller can begin.

3

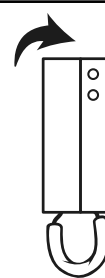

To end the call replace the handset back on the cradle.

TO OPEN THE DOOR

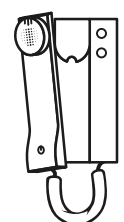

During a conversation

1

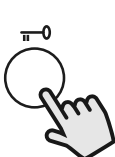

2

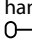

During a conversation, with the handset lifted, press the lock button  to operate the lock. To end the call replace the handset back on the cradle.

CALL TONE VOLUME ADJUSTMENT

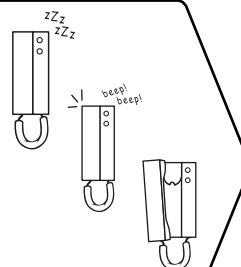

In every situation

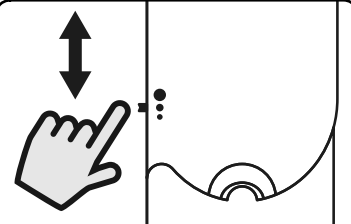

Move the volume switch to the lower position to set the call tone volume to low, to the middle position to set the call tone volume to medium and to the upper position to set the call tone volume to high.

MAKING A CALL TO THE CONCIERGE

ZZZ ZZZ



In standby

1

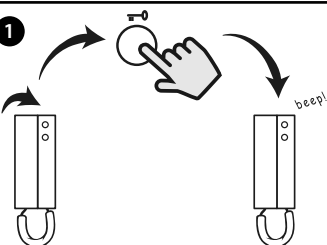

With the handset on the cradle press the lock button  once. The phone will emit a beep, to indicate a call has been placed to the concierge.

2

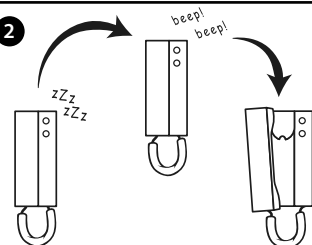

Wait for the callback from the concierge. After a brief delay the phone will ring. When the phone rings pick up the handset to answer the call.

3

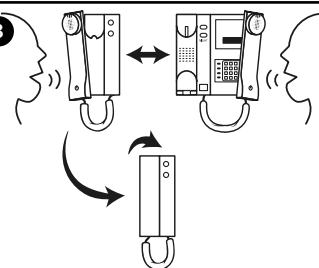

A conversation can begin between the phone and concierge. When the conversation is finished replace the handset back on the cradle.

SPARE SERVICE BUTTON

ZZZ ZZZ

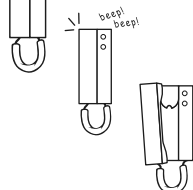

In every situation

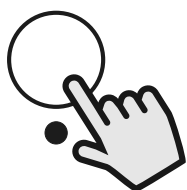

Press the spare service button to activate a secondary function (if this was set up during the installation).

TECHNICAL ADVICE

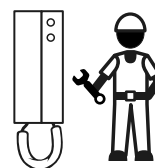

For further technical advice and assistance on the installation of this product please contact Videx technical on tel: 0191 224 3174.

For any sales advice and assistance please contact Videx sales on tel: 0191 238 8324.

To download a copy of this quick guide visit the Videx website: www.videxuk.com